

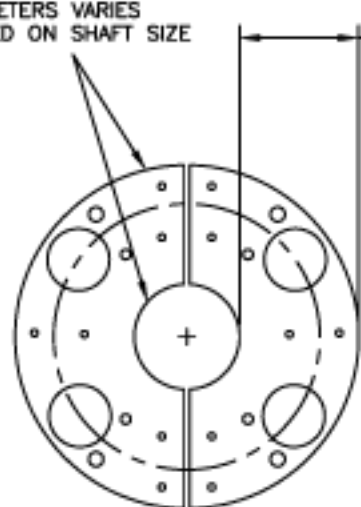

129 Christian Service Camp Rd.
 Washington, N.C. 27889
 Plant 252-975-3101
 FAX 252-975-3949

DIAMETERS VARIES
 BASED ON SHAFT SIZE



PRESSURE
 RELIEF
 VALVE

3 3/4"
 MINIMUM

QTY. OF FOUR GREASE
 POINTS REQUIRED FOR
 TRUE FOUR POINT
 LUBRICATION

TIE WRAP, SADDLES
 AND P TYPE HOSE CLAMP
 SECURE TUBING TO SHAFT
 (INCLUDED) TYP.

SLIP YOKE

1/4" TUBING FOR 6' SHAFTS,
 3/8" TUBING FOR LENGTHS
 OVER 6'
 (INCLUDED)

QTY. OF FOUR
 GREASE POINTS
 REQUIRED FOR
 TRUE FOUR POINT
 LUBRICATION

10" MIN

15 1/2

FLEXIBLE PIG TAIL

C/C DISTANCE OF SHAFT

SHAFT RPM _____

SHAFT SIZE DIAMETER _____

C/C LENGTH OF SHAFT _____

DISTANCE FROM EITHER END OF SHAFT TO WHERE THE TRUELUBE FRAME WILL BE MOUNTED _____

SLIP JOINT OR NOT _____ LENGTH OF TRAVEL _____

CLEARANCE FOR TRUE LUBE _____
 CLEARANCE REQUIRED FOR 1" Ø TO 8-1/2" Ø SHAFTS IS 15-3/4"
 CLEARANCE FOR LARGER DIAMETERS MUST BE DETERMINED BY SHAFT SIZE

TYPE OF GREASE REQUIRED _____

TRUE LUBE FRAME MATERIAL
 316L SS _____ OR 6061 ALUMINUM _____

NUMBER OF LUBRICATION POINTS PER JOINT _____

REV	DESCRIPTION	BY	DATE	DWG. BY: RDC	APPD. BY:	CKD. BY: .	SCALE: A
A	REVISED VIEW TO SHOW NEW TUBING LAYOUT AND FITTINGS	AMU	8/28/07	DATE: 06-21-04	MAT: .		DWG.# CMW04154 REV A